

ZONING MAP

REDDING, CONNECTICUT

ZONES:

- | | |
|------------------------------|----------------------------------|
| R-4 Conservation Residential | SDD Special Development District |
| R-2 Rural Residential | NB Neighborhood Business |
| R-1 Low Density Residential | SB Service Business |
| R-1/2 Suburban Residential | BC Business Center |
| RV Village Residential | OR Office & Research Park |
| HMC Historic Mill Center | |

Zone boundary lines, except where otherwise noted, follow Town boundaries, centerlines of road rights-of-way, and lot lines of record, or are parallel or perpendicular thereto. Refer to Zoning Regulations of the Town of Redding for standards governing each zone and for rules for determination of zone boundaries.

Map officially adopted February 1, 1986; amended to January 1, 2002

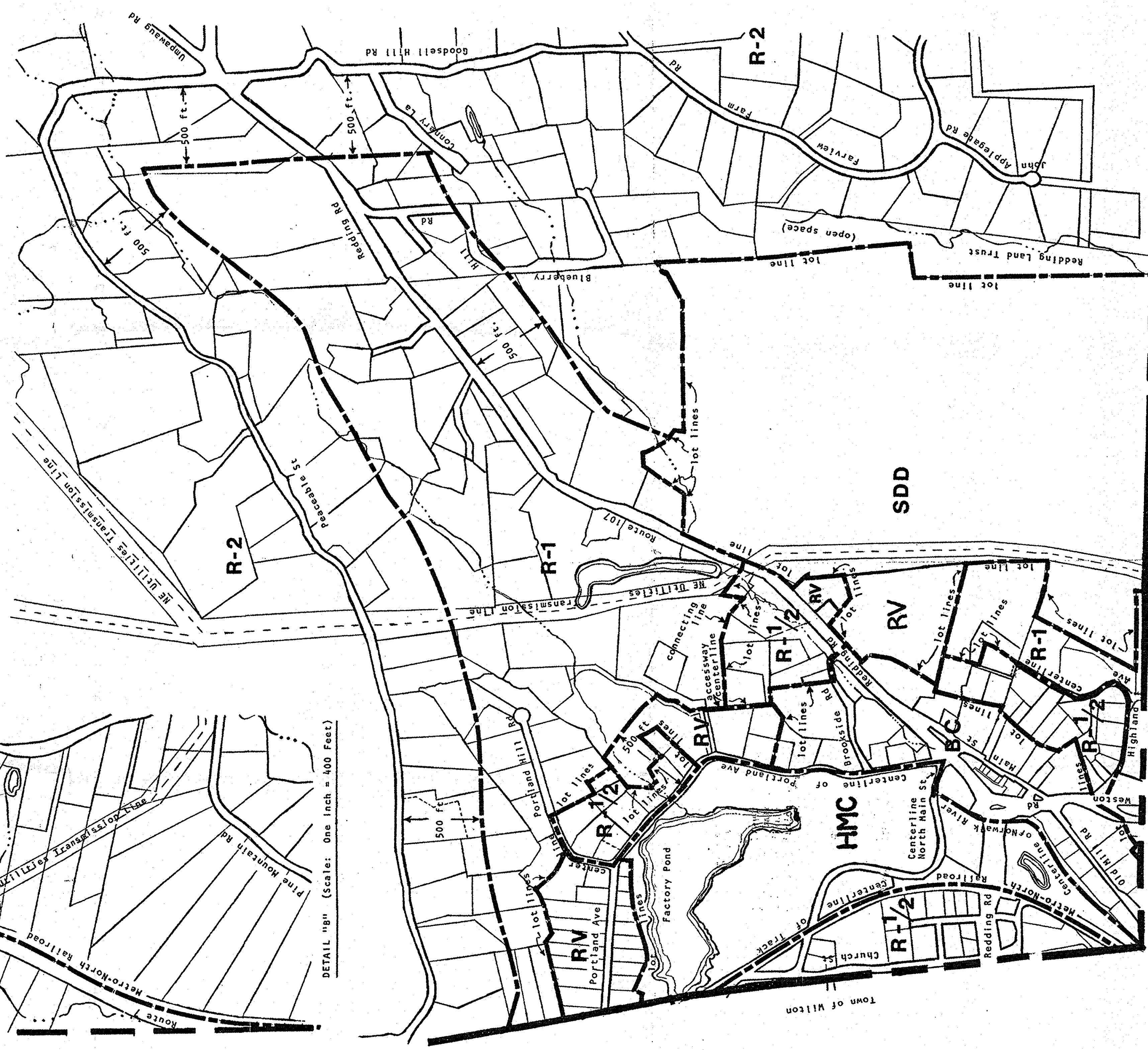
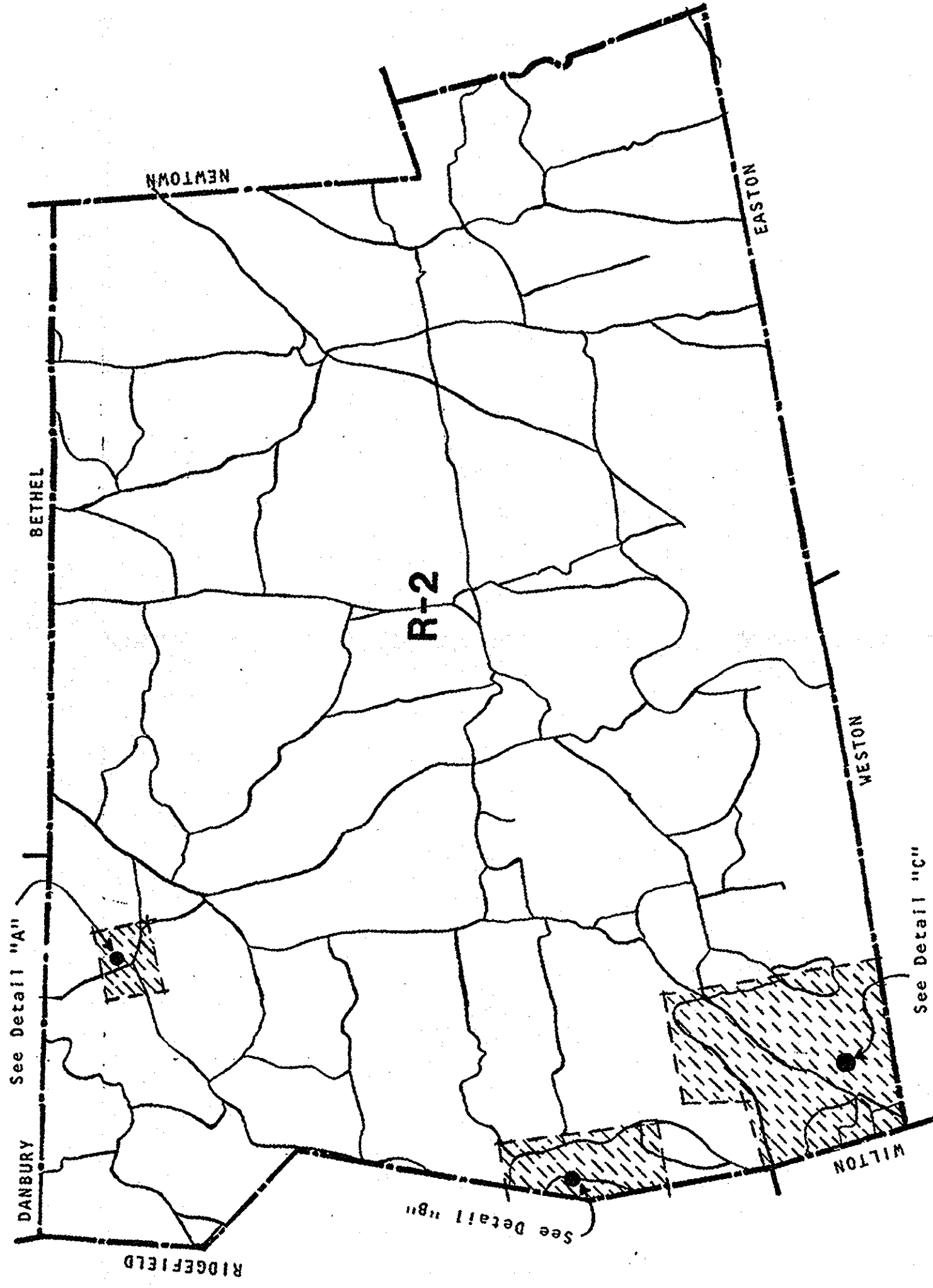
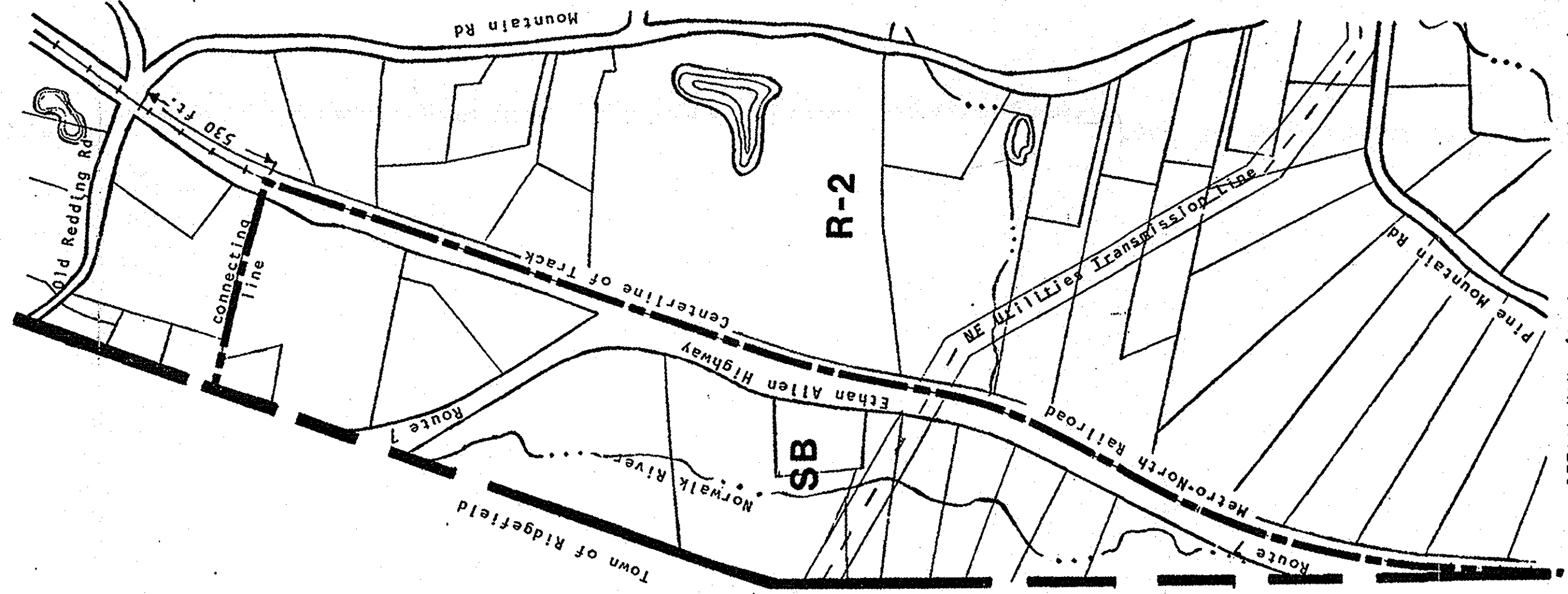
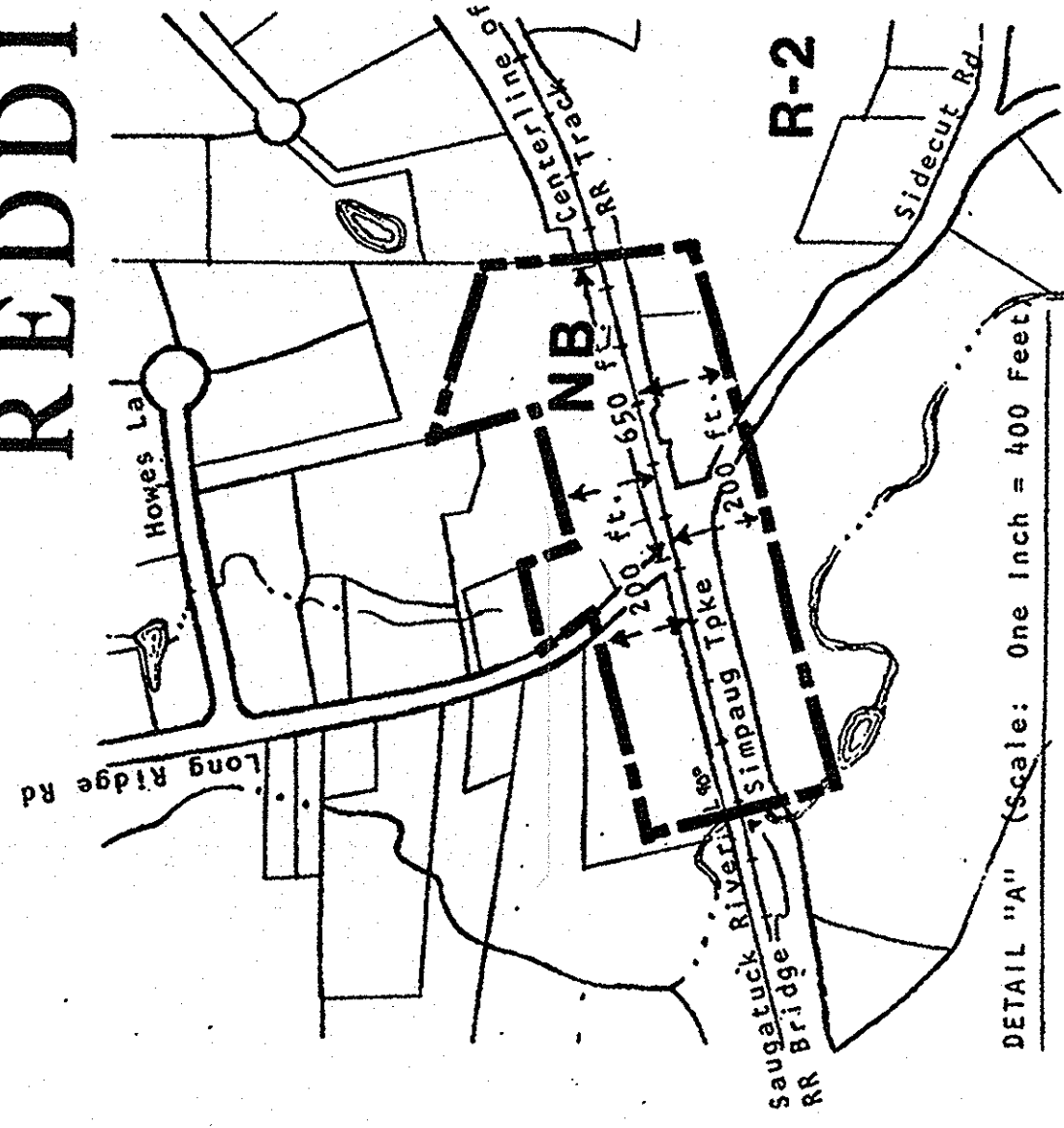

DETAIL "A" (Scale: One Inch = 400 Feet)

DETAIL "B" (Scale: One Inch = 400 Feet)

DETAIL "C" (Scale: One Inch = 400 Feet)

Town of Weston

Town of Milton